

MOORE SCHOOL OF ELECTRICAL ENGINEERING  
UNIVERSITY OF PENNSYLVANIA

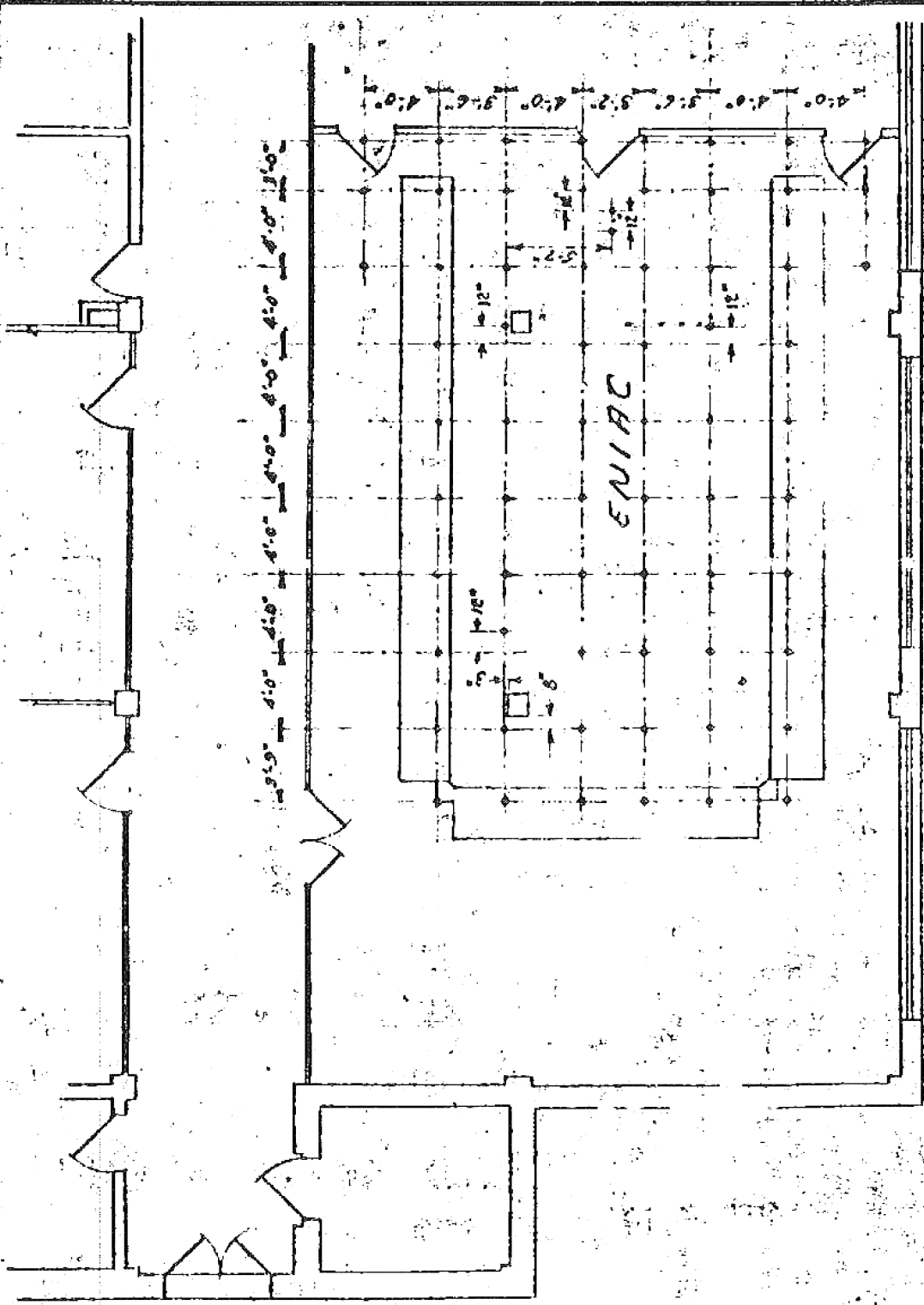

68 -  $\frac{5}{8}$ " DIA. INSERTS REQUIRED  
IN CEILING OF ENIAC ROOM

NOTE: SEE ALSO WM. T. CAMERON  
CO.'S DRAWING FOR INSERTS  
REQUIRED BY VENTILATION  
CONTRACTOR.

~ INSERT LOCATIONS ~

DRAWN BY J.A.C. 3-18-46  
CHECKED BY do 3-18-46  
APPROVED BY

ENIAC INSTALLATION  
COMPUTING ANNEX - THIRD FLOOR  
BALLISTIC RESEARCH LABORATORY  
ABERDEEN PROVING GROUND

SCALE  $\frac{1}{8}" = 1'-0"$   
PX-14-105

201-11-20